

This Guide is intended for quick consultation only and does not replace the Use and Maintenance Manual. Before using the machine, read the Use and Maintenance Manual contained in the machine packaging thoroughly and rigorously respect all the instructions.

PREPARATION/ OPERATION

Fill the detergent tank.

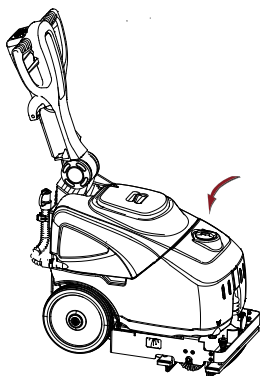

Adjust the slope of the handle by pulling the handle release lever.

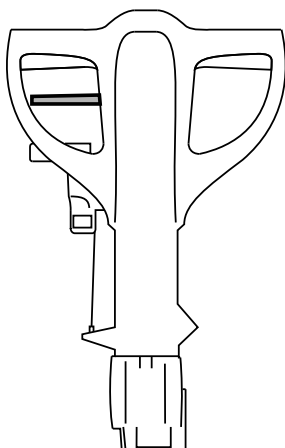

Open the detergent tank tap.

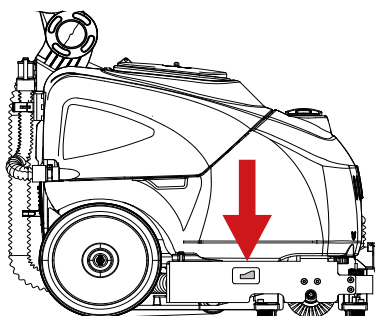

Press the ON button.

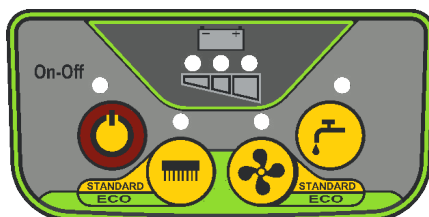

Press the brush button to activate suction and water delivery.

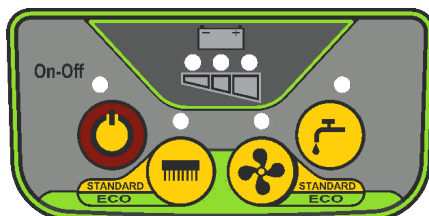

Operate the drive lever.

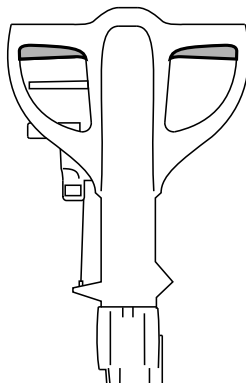

Begin working.

When you have finished cleaning, proceed as follows:

- Press the brush button.
- Turn the machine off by pressing the ON button for at least 4 seconds.
- Raise the squeegee.
- Close the detergent tank tap.
- If necessary, charge the batteries (BATTERY VERSION)

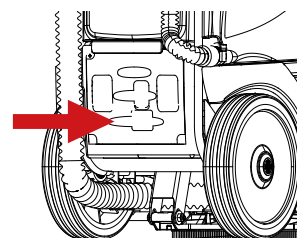

DAILY MAINTENANCE

Empty the dirty water tank.

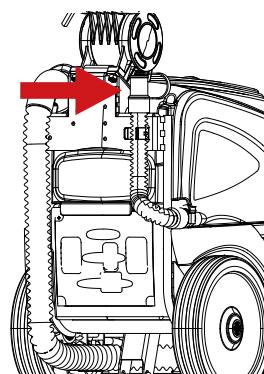

Clean the dirty water tank.

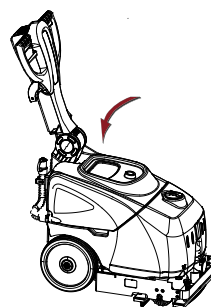

Check the detergent output filter is undamaged and clean.

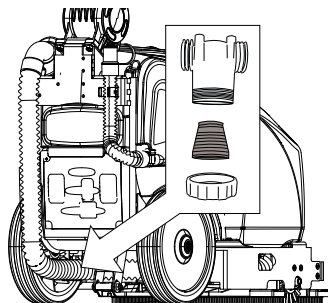

Check the dirty water tank float is undamaged and clean and moves freely on the pin.

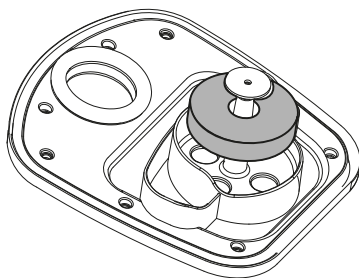

Clean the brush.

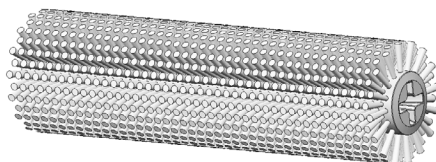

Check the squeegee is clean and the blades are not damaged.

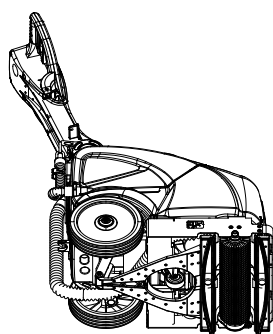

Check the battery charge (BATTERY VERSION).

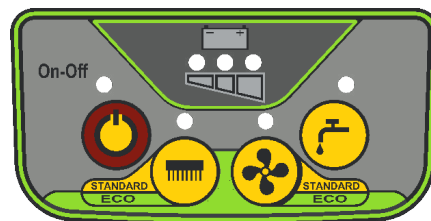

To recharge the batteries, plug in the battery charger, using the extension provided with the machine.

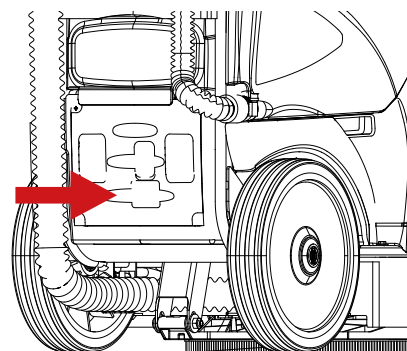

REPLACING THE SQUEEGEE BLADES

- remove the two squeegees by unscrewing the screws;
- turn the squeegees over;
- remove the worn blades by pulling them off, and then replace them with new ones, inserting the protruding tooth into the socket;
- replace the squeegee on its support;

AUTOMATIC BRUSH ATTACHMENT

Mounting the brush:

- switch the machine off, unplug the cable version from the power socket; raise the front of the machine by hand; with the other hand, insert the brush and push it upwards until it clicks into position.

Removing the brush:

- switch the machine off, unplug the cable version from the power socket; raise the front of the machine by hand; with the other hand, remove the brush by pulling it downwards; lower the machine.

| | |
|---|--|
| THE MACHINE DOES NOT COME ON/START UP | CHECK THE BATTERY CHARGE (BATTERY VERSION) |
| | CHECK THE POWER CABLE IS PLUGGED INTO A FUNCTIONING SOCKET (CABLE VERSION) |
| THE MACHINE LEAVES THE FLOOR WET | CHECK THE SQUEEGEE BLADES ARE NOT WORN |
| | CHECK THERE IS NO DEBRIS BETWEEN THE TWO SQUEEGEE BLADES |
| | CHECK THERE IS NO DEBRIS IN THE SUCTION HOSE |
| | CHECK THE DIRTY WATER TANK IS NOT FULL |
| | CHECK THE DETERGENT TANK LID IS CLOSED CORRECTLY |
| THE MACHINE LEAVES THE FLOOR DIRTY | CHECK THE SUCTION HOSE IS CORRECTLY ATTACHED TO THE SQUEEGEE |
| | CHECK THE TYPE OF BRUSH IN USE IS SUITABLE FOR THE TYPE OF DIRT AND FLOOR. |
| THE MACHINE LEAVES STRIPES OF WET FLOOR | CHECK THE FLOOR HAS BEEN BRUSHED BEFORE USING THE MACHINE |
| | CHECK THERE IS NO DEBRIS BETWEEN THE TWO SQUEEGEE BLADES |
| | CHECK THE SQUEEGEE BLADES ARE NOT WORN |
| | CHECK THE SQUEEGEE IS CORRECTLY ADJUSTED |